

**II B.Tech. I Semester(RR) Supplementary Examinations, May/June 2010**  
**MACHINE DRAWING**  
**(Mechanical Engineering)**

Time: 3 hours

Max Marks: 80

\*\*\*\*\*

**PART-A**  
**(Answer TWO Questions, 2 X 10 Marks)**

1. Draw whitworth standard thread and Buttress thread with a pitch of 20 mm.
2. Draw the Rag foundation bolt with  $D = 30\text{mm}$ .
3. Draw the sectional front view and top view of the double riveted double strap zig zag butt joint with dia of the rivet as 14 mm.

**PART-B**  
**(Compulsory Question, 1 X 60 Marks)**

4. Draw the sectional front view (bottom half in section) and left side view of the assembled eccentric from the given figure and part list. Also draw the top view of the same.

Part List

Part. No.	Name	Material	Quantity
1.	Eccentric strap	C.I.	1
2.	Eccentric strip	C.I.	1
3.	Sheave	C.I.	1
4.	Strap bolt	M.S.	2
5.	Packing strip	Leather	2
6.	Nut	M.S.	2
7.	Nut	M.S.	2

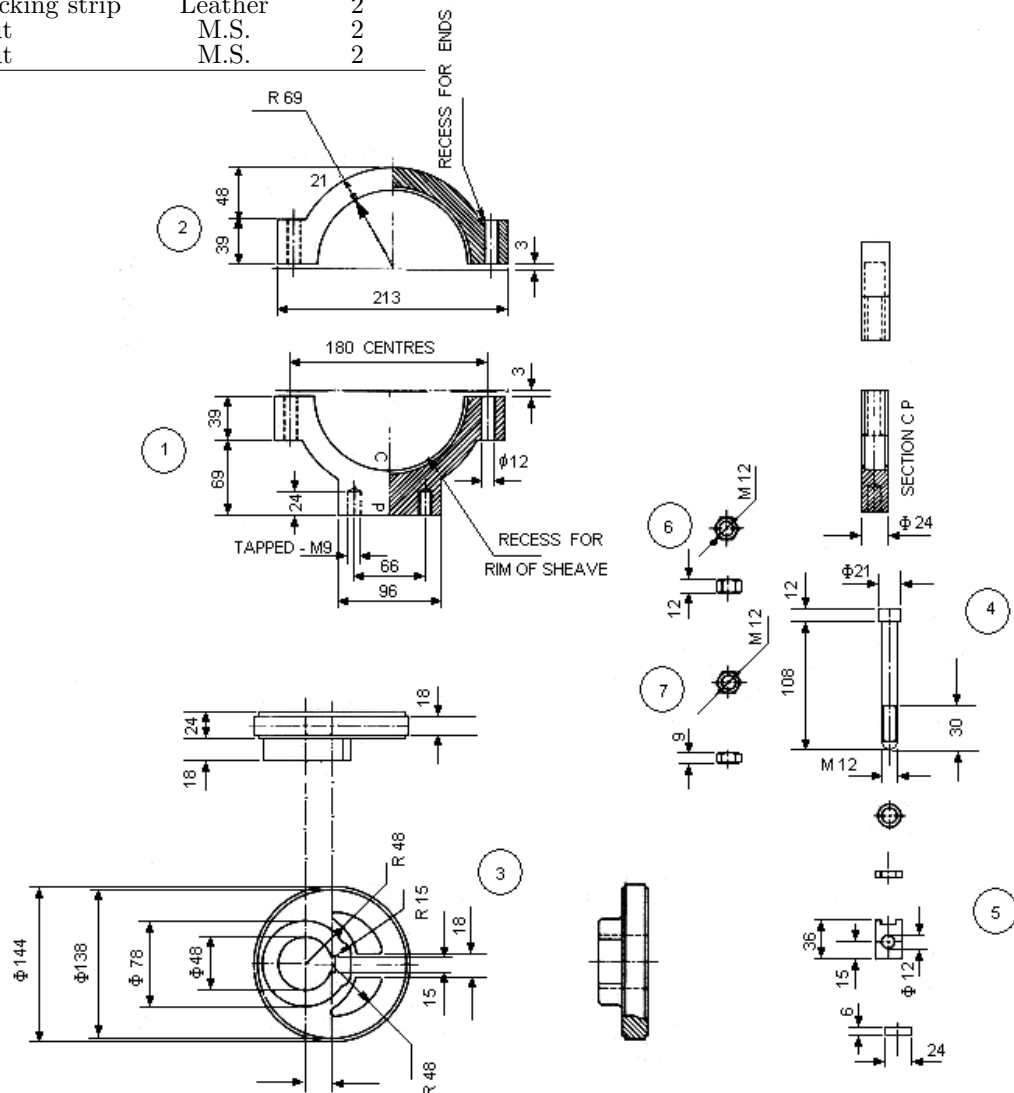

\*\*\*\*\*